



# Supply Chain Management user conference

## Agenda

November 3 - 7, 2008

The Fairmont Olympic Hotel  
Seattle, Washington



## Registration and Conference Information

The AspenTech Conference Sessions, Breakfasts, Lunches, and scheduled Receptions are located in the Fairmont Olympic Hotel on the first, second, and mezzanine floors.

Upon your arrival, please go to the AspenTech Registration Desk located in the Spanish Foyer on the main lobby to pick up all conference materials and badges. The Registration/Information Desk is available throughout your stay at the conference to answer questions and assist with any of your needs.







### Registration/Information Desk Hours

Sunday, November 2nd	3:00 p.m. to 8:00 p.m.
Monday, November 3rd	7:00 a.m. to 4:00 p.m.
Tuesday, November 4th	7:00 a.m. to 4:00 p.m.
Wednesday, November 5th	7:00 a.m. to 4:00 p.m.
Thursday, November 6th	7:00 a.m. to 4:00 p.m.
Friday, November 7th	7:00 a.m. to 12:00 p.m.

### Badges, Lanyards, and Ribbons

When you check in at the AspenTech Registration Desk, you will receive your conference materials along with a name badge that includes your company and your primary conference track. Make sure your badge is correct and, if not, someone from the Registration Desk will be glad to help you. You will also receive a colored lanyard indicating your group or area of interest:

#### Lanyards:

	<b>RED</b> - Planning (PIMS)
	<b>BLUE</b> - Scheduling (Orion)
	<b>GREEN</b> - Supply Chain (SCM)
	<b>LIME GREEN</b> - Executive Advisory Board (EAB)
	<b>BURGUNDY</b> - Other
	<b>BLACK</b> - Guest
	<b>GOLD</b> - Aspen Technology

#### Ribbons:

In addition, some badges will have ribbons to easily identify speakers and staff:

 **Blue** ribbons indicate Conference Speakers who have directly contributed to the event.

 **Sky Blue** ribbons indicate Conference Staff that you can approach any time to help with your questions and concerns.

**Please note:** It is CRITICAL that you wear your conference badge at all times for security reasons. You will not be allowed access into any session or event if you are not wearing your badge.

### Conference Meals

Breakfast will be served on Monday and Tuesday from 7:30 to 9:00 a.m., and Wednesday through Friday from 7:30 to 8:30 a.m. Lunch will be served Monday through Thursday, check the agenda for exact times. For dinner, we will host a spectacular Welcome Reception on Monday and a Celebration Dinner on Tuesday—both at exciting off-site locations.

### No Smoking Policy and Cell Phone Usage

The User Conference meetings and activities are non-smoking. Please turn your cell phone off during the sessions.

### Dress

Dress during all Conference sessions is business casual. The temperature ranges from the low 50s during the day to the low 40s in the evening. The long-range forecast calls for showers, so rain gear is recommended. A light jacket and comfortable walking shoes are advised for all tours.



# Supply Chain Management user conference

## Registration Hours - Hotel Spanish Foyer

Date	Time
Sunday, November 2nd	3:00 PM - 8:00 PM
Monday, November 3rd	7:00 AM - 4:00 PM
Tuesday, November 4th	7:00 AM - 4:00 PM
Wednesday, November 5th	7:00 AM - 4:00 PM
Thursday, November 6th	7:00 AM - 4:00 PM
Friday, November 7th	7:00 AM - 12:00 PM

## Executive Advisory Board Meeting

Date	Time	Location
Monday, November 3rd	9:00 AM - 5:00 PM	St. James
	12:00 PM - 2:00 PM	Executive Advisory Board Lunch - Kensington
Tuesday, November 4rd	2:00 PM - 5:00 PM	St. James
Wednesday, November 5rd	8:30 AM - 12:00 PM	St. James
	12:00 PM - 1:30 PM	Executive Advisory Board Lunch - Kensington

## Monday, November 3rd

Time	Planning	Scheduling	Supply Chain
7:30 AM - 9:00 AM	Breakfast - Spanish Foyer		
9:00 AM - 10:30 AM	<b>PIMS New Release Training</b> <i>Vibeke Stevens - Aspen Technology</i> Code: P011 Spanish Ballroom	<b>Scheduling New Release Training</b> <i>Zafar Ali - Aspen Technology</i> Code: S011 Metropole	<b>Supply Chain New Release Training</b> <i>General CAPs Foundation and Collaborative Demand Management</i> <i>Dean Belitskus - Aspen Technology</i> Code: SC011 Congress
10:00 AM - 1:45 PM	Guest Program #1 - Pike Place Market Culinary Tour - Meet @ Kensington Room		
10:30 AM - 11:00 AM	Break - Foyers		
11:00 AM - 12:30 PM	<b>PIMS New Release Training</b> <i>Vibeke Stevens - Aspen Technology</i> Code: P012 Spanish Ballroom	<b>Scheduling New Release Training</b> <i>Zafar Ali - Aspen Technology</i> Code: S012 Metropole	<b>Supply Chain New Release Training</b> <b>Supply Planner</b> <i>Laurie Tuschen - Aspen Technology</i> Code: SC012 Congress
12:00 PM - 2:00 PM	Lunch - Spanish Foyer		
2:00 PM - 3:30 PM	<b>PIMS New Release Training</b> <i>Vibeke Stevens - Aspen Technology</i> Code: P013 Spanish Ballroom	<b>Scheduling New Release Training</b> <i>Dimitri Varvarezos - Aspen Technology</i> Code: S013 Metropole	<b>Supply Chain New Release Training</b> <b>Plant Scheduler</b> <i>John Hellebusch - Aspen Technology</i> Code: SC013 Congress
3:30 PM - 4:00 PM	Break - Foyers		
4:00 PM - 4:30 PM	<b>PIMS New Release Training</b> <i>Vibeke Stevens - Aspen Technology</i> Code: P014 Spanish Ballroom	<b>Scheduling New Release Training</b> <i>Zafar Ali - Aspen Technology</i> Code: S014 Metropole	<b>Supply Chain New Release Training</b> <b>Scheduling Insight</b> <i>John Hellebusch - Aspen Technology</i> Code: SC014 Congress

6:00 PM - 9:00 PM **Welcome Reception at the Seattle Space Needle O Deck - Depart Hotel @ 5:30 PM from The Garden**

Please join us as we kick off the User Conference in grand style with a Welcome Reception at the famous Seattle Space Needle! That's right, we're all gathering at the Space Needle's O Deck featuring spectacular, panoramic views of Seattle and Puget Sound. Join your peers for an exclusive private party, complete with cocktails, dinner, and lively conversation—high atop Seattle's most recognized landmark.

Tuesday, November 4th			
Time	Planning	Scheduling	Supply Chain
7:30 AM - 9:00 AM	Breakfast - Spanish Foyer		
9:30 AM - 3:00 PM	Guest Program #2 - Seattle Favorites - Meet @ Kensington Room		
9:00 AM - 10:40 AM	<b>AspenTech Plenary</b> <i>This year marks the first time that we will bring together petroleum, olefin, chemical, polymer, spec chem, and process CPG industries. The combined plenary will address key industry challenges and provide insight into new strategies for capitalizing on growing opportunities.</i> Charles Rieb - Aspen Technology Code: AT02a Spanish Ballroom		
	Charles Johnson - Microsoft Code: AT02b Spanish Ballroom		
	<b>Augmenting Statistical Forecasts with Market Intelligence</b> Mike Wallin - Bridgestone Americas Code: AT02c Spanish Ballroom		
10:40 AM - 11:10 AM	Break - Foyers		
11:10 AM - 12:10 PM	<b>Petroleum Plenary</b> <i>Interesting analyses of property giveaway in fuels, monetization of simple property giveaway in gasoline, and discussion of how refiners are managing giveaway.</i> John Popielarczyk - Solomon Associates Code: PS021a Spanish Ballroom		<b>Supply Chain Management Track</b> <b>Cabot's Implementation of Plant Scheduler</b> Anthony Phillips - Cabot Code: SC021a Congress
	Charles Rieb, VP Product Management, will present the overall Petroleum Manufacturing Supply Chain Roadmap for the next three software release cycles. Charles Rieb - Aspen Technology Code: PS021b Spanish Ballroom		<b>Supply Chain Management Track</b> <b>Regression Testing: Simplify SOX compliance, upgrades, and code promotion</b> Floyd Nasuti - Aspen Technology Code: SC021b Congress
12:10 PM - 12:40 PM			<b>Supply Chain Management Track</b> <b>Supply Chain model sustainability: Aligning applications with your business as it changes</b> Angela Williams - Westlake Chemicals Code: SC021c Congress
12:30 PM - 2:00 PM	Lunch - Spanish Foyer		
1:45 PM - 2:15 PM	<b>PIMS Track</b> <b>The PIMS Roadmap</b> Rob Bishop - Aspen Technology Code: P021a Spanish Ballroom		
2:15 PM - 2:45 PM	<b>PIMS Track</b> <i>The valuation of the PIMS AO model of an upstream oil gathering network</i> Graham Jones - Saudi Aramco Code: P021b Spanish Ballroom	<b>Scheduling Track</b> <b>Crude Segregation Planning in Orion</b> Joe Evans - Exxon Code: S021a Metropole	<b>Supply Chain Management Track</b> <b>A scalable, globally standard integration between aspenONE™ Planner and Scheduler and SAP</b> Kris Tenbarge - Procter & Gamble Code: SC022a Congress
2:45 PM - 3:15 PM	<b>PIMS Track</b> <b>PIMS AO Infeasibility Tutorial</b> Tekin Kunt - Aspen Technology Code: P021c Spanish Ballroom	<b>Scheduling Track</b> <b>Planning Directives to Scheduling</b> Partha Sengupta - Shell Code: S021b Metropole	<b>Supply Chain Management Track</b> <b>AspenTech's SCM as a Mission-Critical System</b> Naishadh Kapadia - Logexsoft Code: SC022b Congress
3:15 PM - 3:45 PM	Break - Foyers		

Tuesday, November 4th (Cont.)			
Time	Planning	Scheduling	Supply Chain
3:45 PM - 4:15 PM	<b>PIMS Track</b> <i>Visual Analytics for PIMS</i> Juan Jimenez Violante - Muse Stancil Code: P022a Spanish Ballroom	<b>Scheduling Track</b> <i>Using Orion to Model Multiple Sites (Global Orion)</i> Piyush Patel - Aspen Technology Code: S022a Metropole	<b>Supply Chain Management Track</b> <i>Complex Sequencing Issues in Polymers Scheduling</i> Jack Hitchens - Aspen Technology Code: SC023a Congress
4:15 PM - 5:00 PM	<b>PIMS Track</b> <i>Assessing Risk in the Downstream Distribution Network</i> Mark Zeto - Marathon Code: P022b Spanish Ballroom	<b>Scheduling Track</b> <i>Integrated Marine, Dock, and Refinery Scheduling at Hovensa</i> John Stommel - Hovensa Code: S022b Metropole	<b>Supply Chain Management Track</b> <i>Supply Chain Management at SCG Chemicals Using aspenONE</i> Warren Becraft - Aspen Technology Singapore Code: SC023b Congress
6:30 PM - 10:00 PM	<b>Dinner: An Evening of Mystique at Teatro ZinZanni - Depart Hotel @ 6:00 PM from The Garden</b>		

## Tuesday's Conference Highlights

### 2008 AspenTech Plenary Session

9:00 – 10:40 a.m.  
 Spanish Ballroom

This is the first time ever we have combined the largest refining and petrochemical Planning & Scheduling conference of its kind with a Supply Chain program that includes Aspen PIMS, Aspen Orion, Aspen DPO, and Aspen Advisor User Groups. During this valuable plenary session, we will demonstrate the benefits that you can expect from the entire solution suite, enabling you to meet the challenges of process optimization and achieve operational excellence.

In addition, you will hear from keynote speakers from **Microsoft** and **Bridgestone Americas**, who will share their insights and experiences to help you capitalize on new market opportunities.

### AspenTech Celebration Dinner sponsored by Microsoft

7:00 – 10:00 p.m.  
 Teatro ZinZanni Seattle

You and your guest are cordially invited to join us for an **Evening of Mystique at Teatro**.

Experience an unforgettable and elegant night of transformation and celebration, as you enter into a world of fantasy and magic at Teatro ZinZanni. Described as “the place where Moulin Rouge meets Cirque de Soleil,” Teatro ZinZanni continues to thrill audiences with a unique form of entertainment that combines humor, magic, and mystery.

An ensemble cast of cabaret artists, illusionists, aerialists, comics, and crooners make every night at Teatro ZinZanni a unique experience. Torch singers, tap dancers, magicians, and musicians transform an ordinary evening into a night of enchantment. An ever-evolving and constantly changing production, Teatro ZinZanni combines improv comedy, vaudeville revue, music, dance, cirque, and sensuality into a dizzying and colorful new form that is never quite the same from evening to evening. The fast-paced action of the show unfolds above, around, and even alongside the audience as they dine on a five-course feast created by celebrated Northwest chef Tom Douglas. It's an experience you won't want to miss!



We would like to thank **Microsoft** for their Platinum Sponsorship of this event.



# Supply Chain Management user conference

## Wednesday, November 5th

Time	Planning & Scheduling	Supply Chain
7:30 AM - 8:30 AM	Breakfast - Spanish Foyer	
8:30 AM - 10:00 AM	<b>Planning &amp; Scheduling Breakout 1</b> <i>Driving Economics into Operations (1) - 95%</i> Charles Rieb/Zafar Ali - Aspen Technology John Stommel - Hovensa Code: PS031a Spanish Ballroom	<b>Supply Chain Breakout 1 - Technical Focus</b> <i>Overview and demonstration of Aspen Supply Chain Connect - Improve planning responsiveness with on-demand synchronization with SAP and other ERP systems.</i> Julien Brosseau - Aspen Technology Code: SC031a Council
	<b>Planning &amp; Scheduling Breakout 2</b> <i>Common Model Environment - 75%</i> Dr. Granville Paules/Dr. Tekin Kunt - Aspen Technology Code: PS031b Metropole	
	<b>Planning &amp; Scheduling Breakout 3</b> <i>Customer Reporting Evolution - 63%</i> Laura Foley - Aspen Technology Thierry D'Hers - Microsoft Juan Jimenez - Muse Stencil Code: PS031c Congress	
	<b>Planning &amp; Scheduling Breakout 4</b> <i>Sustainability of Planning and Scheduling Solutions (1) - 68%</i> Mike Byerly/Mike Repke - Aspen Technology Code: PS031d Parliament	
10:00 AM - 10:30 AM	Break - Foyers	
10:30 AM - 12:00 PM	<b>Planning &amp; Scheduling Breakout 5</b> <i>Supply Chain Optimization - 65%</i> Mike Grupa/John Finta - Aspen Technology Code: PS032a Council	<b>Supply Chain Breakout 2 - Business Process Focus</b> <i>aspenONE Planning &amp; Scheduling at HMC Polymers</i> Warren Becraft - Aspen Technology Singapore Code: SC032a Congress  <i>aspenONE and the Carbon Footprint - As companies begin to analyze and reduce their carbon footprint, understand the impact of each segment of the supply chain.</i> Jim Piana - Aspen Technology Code: SC032b Congress  <b>Roundtable/Panel Discussion: Topics include best practices in S&amp;OP, scheduling, change management, implementation approaches, and post-production audits.</b> Elinor Price - Aspen Technology, Moderator Code: SC032c Congress
	<b>Planning &amp; Scheduling Breakout 6</b> <i>PIMS Usability Workshop - 58%</i> Rob Bishop/Purvi Bharwada/Dr. Basil Joffe - Aspen Technology Code: PS032b Metropole	
	<b>Planning &amp; Scheduling Breakout 7</b> <i>Sustainability of Planning and Scheduling Solutions (2) - 68%</i> Mike Byerly/Mike Repke - Aspen Technology Code: PS032c Parliament	
	<b>Planning &amp; Scheduling Breakout 8</b> <i>Driving Economics into Operations (2) - 95%</i> Charles Rieb/Zafar Ali - Aspen Technology John Stommel - Hovensa Code: PS032d Spanish Ballroom	
12:00 PM - 1:30 PM	Lunch - Spanish Foyer	
Afternoon Tours	<b>All Tours Must Be Pre-Registered and Tickets Are Required - All Tours Meet and Depart from the Hotel/Seneca Entrance</b> Boeing Tour <span style="float: right;">Meet @ 1:15 PM - Depart @ 1:30 PM</span> Museum of Flight Tour and Seattle City Highlights <span style="float: right;">Meet @ 1:30 PM - Depart @ 1:45 PM</span> Seattle Center and Pike Place Market Excursion <span style="float: right;">Meet @ 1:45 PM</span>	

## Wednesday's Afternoon Tours

### Boeing Tour

1:30 – 6:00 p.m.

Meet in Lobby at 1:15

Join us for a short 30-minute ride as we motor coach from the hotel to the Future of Flight Aviation Center, where you will take a private, guided tour of the Boeing facility. You'll get an in-depth view into the many facets of the aviation industry, including a look at some of the newest airplanes like the new Boeing 787! The Aviation Gallery features a number of interactive exhibits and displays—you can even design your own airplane.

The 73,000-square-foot Future of Flight Aviation Center & Boeing Tour is one of the region's major attractions you won't want to miss.

### Museum of Flight Tour & Seattle City Highlights

1:45 – 6:00 p.m.

Meet in Lobby at 1:15

Take a guided tour around Seattle and learn more about its history, points of interest, famous landmarks, culture, shopping districts, and more. You'll get the "insider's view" of the city to help you get the most out of your visit. Notable stops include the historic Pioneer Square, Seattle's bustling waterfront, and the Chittenden Locks where you will see how the area's fresh and salt waters meet, and get a chance to view the adjoining salmon ladders. The final stop on the tour is the Museum of Flight where guests can see the history of aviation and view dozens of full-size aircraft.

### Seattle Center & Pike Place Market Excursion

2:00 – 5:00 p.m.

Meet in Lobby at 1:45

On this tour, motor coaches will depart from the Fairmont Olympic Hotel and make stops at the following destinations: **Pike Place Market**, **Seattle Space Needle**, the **Experience Music Project** and the **Sci-Fi Museum**. (Experience Music Project, Sci-Fi Museum, and Seattle Space Needle are about a five-minute walk from each other). Motor coaches will make a continuous loop and stop at each destination every 20 minutes.

**All attendees MUST be pre-registered and tickets are required. Tour participants must be in hotel lobby at least 15 minutes prior to the scheduled departure time.**

## Thursday, November 6th

Time	Planning	Scheduling	Supply Chain
7:30 AM - 8:30 AM	Breakfast - Spanish Foyer		
9:00 AM - 9:30 AM	<b>PIMS Track</b> <i>Economic feasibility study for H2 production from renewable sources using Aspen PIMS.</i> Gilberto Xavier - Petrobras Code: PIMS041a Spanish Ballroom	<b>Scheduling Track</b> <i>Putting the "O" in MBO</i> Kirby English - COP Code: O041a Metropole	<b>Supply Chain Track</b> <i>FP Corporation's Distribution Scheduler Near-Term Distribution Solution</i> David Linkin - Time Commerce Naoshi Hata - Time Commerce Code: SCO41a Congress
9:30 AM - 10:00 AM	<b>PIMS Track</b> <i>The Use of PIMS AO to Execute Complex Capital Investment Scenarios</i> Mike Grupa - Aspen Technology Code: PIMS041b Spanish Ballroom	<b>Scheduling Track</b> <i>Management of the Migration to a New Orion (V10) at Total</i> Magali Peysson - Total Code: O041b Metropole	<b>Supply Chain Track</b> <i>Microsoft and the Supply Chain: Trends, Investments, and Applications</i> Colin Masson - Microsoft Code: SCO41b Congress
10:00 AM - 10:35 AM	<b>PIMS Track</b> <i>Parallel Computing Extensions</i> Dr. Dimitri Varvarezos - Aspen Technology Code: PIMS041c Spanish Ballroom	<b>Scheduling Track</b> <i>Using Orion to Manage FCC Feedstock</i> Lionel Bes - Total Code: O041c Metropole	
10:35 AM - 11:05 AM	Break - Foyers		
11:05 AM - 11:35 AM	<b>PIMS Track</b> <i>Crude Manager Integration into PIMS</i> Magnus Eide - Statoil Rachel McCarthy - Spiral Software Code: PIMS042a Spanish Ballroom	<b>Scheduling Track</b> <i>Blending Improvements</i> Himal Munsif - Chevron Code: O0421a Metropole	<b>Supply Chain Track</b> <i>aspenONE Planning &amp; Scheduling Roadmap and Development Strategy</i> - Hear about new features to enhance your Supply Chain business processes, such as Collaborative Forecasting and Scheduling enhancements. - Learn about exciting changes for future releases including how AspenTech is incorporating .NET capabilities into the Planning & Scheduling applications and solving larger, more complex problems with 64-bit processing. Laura Foley/Matt Finnie - Aspen Technology Code: SCO42 Congress
11:35 AM - 12:05 PM	<b>PIMS Track</b> <i>Business Process Deployment for Crude Selection</i> P Raman P Gulati - BPCL Code: PIMS042b Spanish Ballroom	<b>Scheduling Track</b> <i>Orion V8 Roadmap</i> Zafar Ali - Aspen Technology Code: O0421b Metropole	
12:05 PM - 12:35 PM	<b>PIMS Track</b> <i>Modeling Gradient Swing Cuts with PIMS AO</i> Mike Grupa - Aspen Technology Code: PIMS042c Spanish Ballroom		
12:35 PM - 2:00 PM	Lunch - Spanish Foyer		
<b>Time</b>	<b>Planning &amp; Scheduling</b>		
2:00 PM - 3:30 PM	<b>Planning &amp; Scheduling Breakout 9</b> <i>Next-Generation Crude Modeling (1) - 75%</i> Dr. Maurice Jett/Paul Gallagher - Aspen Technology Code: PS043a Spanish Ballroom		
	<b>Planning &amp; Scheduling Breakout 10</b> <i>Crude Manager - 40%</i> Pat Swafford/Rachel McCarthy - Spiral Software Code: PS043b Parliament		
	<b>Planning &amp; Scheduling Breakout 11</b> <i>LP Infeasibility Analysis (1) - 68%</i> Dr. Tekin Kunt/Rob Bishop - Aspen Technology Code: PS043c Metropole		

## Thursday, November 6th (Cont.)

Time	Planning & Scheduling
2:00 PM - 3:30 PM	<b>Planning &amp; Scheduling Breakout 12</b> <b>Computing Advances - 45%</b> <i>Purvi Bharwada/Dr. Dimitri Varvarezos - Aspen Technology</i> <i>Saptak Sen/Lynn Lewis - Microsoft</i> Code: PSO43d Congress
3:30 PM - 4:00 PM	<b>Break - Foyers</b>
4:00 PM - 5:30 PM	<b>Planning &amp; Scheduling Breakout 13</b> <b>LP Infeasibility Analysis (2) - 68%</b> <i>Dr. Tekin Kunt/Rob Bishop - Aspen Technology</i> Code: PSO44a Metropole
4:00 PM - 5:30 PM	<b>Planning &amp; Scheduling Breakout 14</b> <b>Common Model Environment - 75%</b> <i>Dr. Granville Paules/Zafar Ali - Aspen Technology</i> Code: PSO44b Congress
4:00 PM - 5:30 PM	<b>Planning &amp; Scheduling Breakout 15</b> <b>Next-Generation Crude Modeling (2) - 75%</b> <i>Dr. Maurice Jett/Paul Gallagher - Aspen Technology</i> Code: PSO44c Spanish Ballroom
4:00 PM - 5:30 PM	<b>Planning &amp; Scheduling Breakout 16</b> <b>New Matrix Generator - 60%</b> <i>Dr. Stacy Janak/Dr. Basil Joffe - Aspen Technology</i> Code: PSO44d Parliament

## Friday, November 7th

Time	Planning	Scheduling
7:30 AM - 8:30 AM	<b>Breakfast - Spanish Foyer</b>	
8:30 AM - 9:00 AM	<b>Planning Track</b> <b>PIMS AO Effect on the Planning Work Process</b> <i>Peri Sarma - Reliance</i> Code: P041a Spanish Ballroom	<b>Scheduling Track</b> <b>Scheduling &amp; Performance Management System: Bridge Plan vs. Actual Ga</b> <i>Ines Feyo - Galp (remote)</i> <i>Piyush Patel - Aspen Technology</i> Code: P041a Metropole
9:00 AM - 9:30 AM	<b>Planning Track</b> <b>Primary Distribution Optimization in SINOPEC Using Aspen DPO</b> <i>Xing You He - Petro-Cyberworks Information Technology Company Limited</i> <i>Fengrui Wang - Sinopec</i> P041b Spanish Ballroom	<b>Scheduling Track</b> <b>This is an open discussion with Orion/MBO/AOS clients where they can present their concerns, ideas, and any other issues about the PIMS product.</b> <b>Schedule/Blending Forum</b> Code: P042 Metropole
9:30 AM - 10:05 AM	<b>Planning Track</b> <b>Challenges and Successes Implementing MPIMS in a Planning and Operations Scheduling Environment</b> <i>Charl Germishuizen - Sasol</i> Code: P041c Spanish Ballroom	
10:05 AM - 10:35 AM	<b>Break - Foyers</b>	
10:35 AM - 1:00 PM	<b>Planning Track</b> <b>This is an open discussion with PIMS clients where they can present their concerns, ideas, and any other issues about the PIMS product.</b> <b>PIMS Forum</b> Code: P042a Spanish Ballroom	

## Spouse/Guest Program

All registered guests have access to scheduled breakfasts, lunches, the Welcome Reception, and the Celebration Dinner. Spouses/guests can also participate in the following tour options on Monday and Tuesday.

### **Pike Place Market Culinary Tour Monday, November 3rd**

10:00 a.m. – 1:45 p.m.

Meet in the Kensington Room at 9:40

On this tour, guests will eat their way through Seattle's most celebrated culinary landmark, Pike Place Market. "The Market" is known for its exciting sights, sounds, and aromas. It was started on August 17, 1907 and now, a century after it's founding, remains a vital part of Seattle's social and economic fabric. The nine-acre historic district hosts an estimated nine million visitors each year who come to experience a feast for the senses and shop for an incredible diversity of products. Helping to make up the Market experience, are local farmers, craftspeople, the infamous fish throwers, and more.

By going behind the scenes at the market, you will experience some of the most sought-after market stops and interesting local creations. Throughout the tour, you will taste locally made food and beverages, while meeting and interacting with the eclectic community that frames Pike Place's lively market atmosphere.

### **Seattle Favorites Tour Tuesday, November 4th**

9:30 a.m. – 3:00 p.m.

Meet in the Kensington Room at 9:15

On this tour guests will visit some of Seattle's most famous (and favorite) places. First, you will travel to Pioneer Square to Glasshouse Studio for a live glassblowing demonstration. Seattle has become internationally recognized as the center for glass art in the world, second only to Venice, Italy. This tour captures the spirit of glassblowing and you will walk away with a love and appreciation for this unique form of art.

Next, guests will travel to a local Starbucks coffee store. Here a Starbucks Coffee Education Specialist, along with Starbucks Baristas, will board the motor coach for a private coffee tasting and education. This unique experience will give guests a true taste of Seattle.

After enjoying their Starbucks coffee, guests will visit Blowing Sands Glass Studio, featuring renowned glass artist and studio owner, David Smith. David's art glass is collected and appreciated around the world, and his glass castings are installed in the Atlanta Federal Building as well as public and private buildings in the Northwest.

Guests will then travel to Chinook's for lunch. Chinook's at Salmon Bay is a casual, high-energy seafood restaurant located in the heart of Seattle's Fishermen's Terminal. This unique location has been the base of the North Pacific fishing fleet since 1913 with over 700 commercial fishing vessels calling it home. A local favorite, Chinook's is the perfect setting for your group lunch.

**Guests MUST be pre-registered and tickets are required. All guest tours are required to meet in the Kensington Room 15 minutes prior to departure time. A light jacket and comfortable walking shoes are recommended. Lunch will be provided on both tours.**

LOWER LEVEL

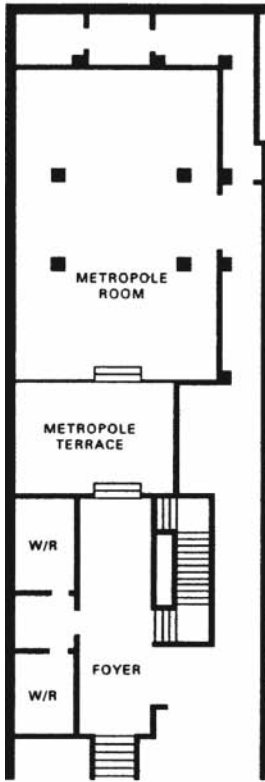

UPPER LEVEL

